

Schedule of Rates and Charges and
Regulations Governing General

LOCAL TELEPHONE EXCHANGE SERVICE

Applying in the Exchanges of this Company, in Michigan
as Designated in the Index of Exchanges
and Local Service Area

TABLE OF CONTENTS AND CHECK LIST

<u>Subject</u>	<u>Sheet Number</u>	<u>Revision</u>	<u>Issued</u>
Title Page	1	Original	03/22/93
Table of Contents and Check List	2	12 th	*10/02/07
Subject Index	3	2 nd	01/06/00
Subject Index	3.1	Original	03/22/93
Subject Index	3.2	1 st	04/23/97
Application and General Provisions	4	Original	03/22/93
Index of Exchanges and Local Service Area	5	Original	03/22/93
Local Exchange Service	6	5 th	*10/02/07
Local Exchange Service	6.0.1	Original	*10/02/07
Local Exchange Service	6.1	1 st	02/07/03
Local Exchange Service	6.2	Original	02/07/03
Local Service Area (Map Sheet)	7	Original	03/22/93
Application of Boundary Designations	8	Original	03/22/93
	9	1 st	04/23/97
	9.1	1 st	04/23/97
Service Connection, Moves and Changes	10	Original	03/22/93
Service Connection, Moves and Changes	10.1	Original	03/22/93
Lifeline Service	11	6 th	01/10/06
Lifeline Service	11.1	1 st	12/18/97
Federal Programs	12	Original	01/06/00

*Original or revised sheet

Issued: October 2, 2007

Effective: January 1, 2008

Issued under authority of Public Act 179 of 1991 as amended

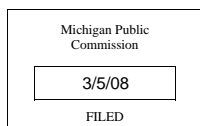

Mark Bernath, President
PO Box 197
Waldron, MI 49288-0197

SUBJECT INDEX

Subject	Sheet	Para.
-A-		
Application and General Provisions of Tariff	4	A
Application of Boundary Designations	8	
-B-		
Boundary Designations, Application of	8	
Business Rates	6	B
-C-		
Changes:		
Charges for	10.1	B
of Interest	10	A.2
-D-		
Definitions:		
Local Service Area	6	A
Service Connection Charges	10	A
Descriptions:		
Boundary	8	
Exchange Service Area	6	C
-E-		
Exchange Service Area:		
Description of	6	C
Map of	7	
Explanation of Symbols	4	B
Extension Rates	6	B
-F-		
Federal Programs	12	(N)
-G-		
General Provisions, Application and	4	B

Issued: January 6, 2000

By: Kathryn Fox, President

Waldron, Michigan

SUBJECT INDEX

Subject		Sheet	Para.
	-I-		
Index of Exchanges and Local Service Area		5	
	-K-		
	-L-		
Lifeline Service		11	A
Local Exchange Tariff		6	
Local Service Area		6	A
	-M-		
Map Sheet		7	
Monthly Rates, Local Service		6	B
	-N-		
	-P-		
	-R-		
Rates, Monthly, Local Service		6	B
Residence Rates, Monthly		6	B
Restoral of Service:			
Definition		10	A.4
Charge		10.1	B.2

Issued: March 22, 1993

Effective: March 22, 1993

Issued under the authority of the Michigan Public Service
Commission Order dated December 22, 1992, in Case No. U-10064.

By: Kathryn Fox, President

Waldron, Michigan

SUBJECT INDEX

Subject	-S-	Sheet	Para.
			(D)
Service Connection Charges:			
Charges for		10.1	B
Definition of		10	A.1
Non-application of		10	A.3
Restoral of Service		10	A.4
Symbols, Explanation of		4	B
	-T-		
Title Page		1	

Issued: April 23, 1997

By: Kathryn Fox, President

Waldron, Michigan

LOCAL TELEPHONE EXCHANGE SERVICE
APPLICATION AND GENERAL PROVISIONS

A. APPLICATION

1. This Tariff applies to Local Telephone Exchange Services of the Waldron Telephone Company - hereinafter referred to as the Telephone Company - in exchanges in Michigan as designated herein.
2. Local Telephone Exchange Service is that of furnishing facilities for telephone intercommunication between customers within a Local Service Area.
3. The provision of service is subject to regulations specified in the M.P.S.C. Tariffs of the Telephone Company, which tariffs as they now exist or as they may be revised, added to, or supplemented by superseding issues are hereby made a part of this Tariff.

B. EXPLANATION OF SYMBOLS

- (C) Signifies a changed regulation.
- (D) Signifies a discontinued rate, treatment or regulation.
- (I) Signifies an increased rate or new treatment resulting in an increased rate.
- (N) Signifies a new rate, treatment or regulation.
- (R) Signifies a reduced rate, or new treatment resulting in a reduced rate.

Issued: March 22, 1993

Effective: March 22, 1993

Issued under the authority of the Michigan Public Service
Commission Order dated December 22, 1992, in Case No. U-10064.

By: Kathryn Fox, President

Waldron, Michigan

WALDRON TELEPHONE COMPANY

INDEX OF EXCHANGES

AND

LOCAL SERVICE AREA

Applying to the following Territory:

Exchange	Incorporated Village	Township	County
Waldron	Waldron	Wright	Hillsdale
		Medina	Lenawee

Issued: March 22, 1993

Effective: March 22, 1993

Issued under the authority of the Michigan Public Service
Commission Order dated December 22, 1992, in Case No. U-10064.

By: Kathryn Fox, President

Waldron, Michigan

LOCAL TELEPHONE EXCHANGE SERVICE

Exchange: WALDRON

A. GENERAL

1. The provision of service at the rates shown below is subject to the regulations given in the General Rules and Regulations as they now exist and are filed with and form part of this Tariff.
2. The rates shown below entitle the customer to messages without other charge to all stations bearing the designation of a central office of the following exchanges, which comprise the Local Service Area:

WALDRON HUDSON MORENCI PRATTVILLE RANSOM

Waldron will block calls dialed 1-plus to stations within the Waldron, Hudson, Morenci, Prattville or Ransom exchanges. Waldron will treat calls dialed without 1-plus as local calls and Waldron will bill those calls according to this tariff.

3. The Company will designate local calls as "Local VNXX Calls" if they meet all of the following criteria:
 - a. The dialed phone number is associated with a rate center included in the calling party's Local Calling Area,
 - b. The end user associated with the called number is not physically located within the rate center associated with the dialed phone number,
 - c. The rate center in which the dialed party is physically located is not within the customer's Local Calling Area,
 - d. The provider of Basic Local Exchange Service to the dialed phone number does not agree to compensate the Company for those calls per the Company's applicable access tariff based on the jurisdiction of a call to the physical location of the dialed party, and
 - e. The Company has posted numbers meeting the above four criteria on the Company's website as Local VNXX Calls.

If a customer so requests, the Company will block direct dialing to all Local VNXX Calls.

(N)
|
(N)

B. BASIC SERVICE RATES, MONTHLY RATES: Within the Base Rate Area:

<u>Class of Service</u>	<u>ALL</u>		
Residence 1-Party Line	\$18.72*		
	<u>NON-EDUCATIONAL</u>		<u>EDUCATIONAL</u>
	<u>6 or fewer lines</u>	<u>7 or more lines</u>	
Business 1-Party Line	\$21.06*	\$18.56*	\$18.56*
PBX Trunk	\$25.26*	\$22.76*	\$22.76*

*The charges for basic local exchange service and end user access line charge were integrated and rates were increased effective July 1, 2001.

Issued: October 2, 2007

Effective: January 1, 2008

Issued under authority of Public Act 179 of 1991 as amended

Mark Bernath, President
PO Box 197
Waldron, MI 49288-0197

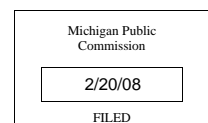

LOCAL TELEPHONE EXCHANGE SERVICE

Exchange: Waldron

C. LOCAL MOU RATE

For calls dialed to a station bearing the designation of a central office within the Waldron, Prattville, or Ransom exchanges, the Company will charge the following:

First 2,000 Conversation MOU in each billing period	\$0.00 per Conversation MOU
Each Conversation MOU over 2,000 in that billing period	\$0.00 per Conversation MOU

For calls dialed to a station bearing the designation of the Hudson or Morenci exchanges, the Company will charge the following:

First 2,000 Conversation MOU in each billing period	\$0.00 per Conversation MOU
Each Conversation MOU over 2,000 in that billing period	\$0.04 per Conversation MOU

For Local VNXX Calls, the Company will charge \$0.04 per MOU plus any local termination charges billed to the Company for that call. (N)
(N)

The Company will measure Conversation MOU from the time when the Company's switching equipment receives answer supervision to the earlier of when the Company's switch receives disconnect supervision from the Waldron switch or from the terminating switch.

The Company will measure local Conversation MOU to the next higher whole MOU per call.

The Company will not bill the end user for non-conversation time related to local calls.

Local Conversation MOU do not include 0-plus or 0-minus calls.

The Company will not provide call record detail for local usage.

No MOU are carried forward from month to month.

Issued: October 2, 2007

Effective: January 1, 2008

Issued under authority of Public Act 179 of 1991 as amended

Mark Bernath, President
PO Box 197
Waldron, MI 49288-0197

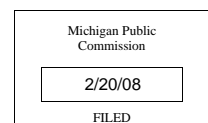

Waldron Telephone Company
M.P.S.C. No. 1(R)

First Revised Sheet No. 6.1
Cancels Original Sheet No. 6.1

LOCAL TELEPHONE EXCHANGE SERVICE

(D)

(D)

Issued: February 7, 2003

Effective: March 1, 2003

Issued under Michigan Public Service Commission order U-13533 dated December 6, 2003.

By: Kathryn Fox, President

Waldron, Michigan

LOCAL TELEPHONE EXCHANGE SERVICE

C. EXCHANGE SERVICE AREA - Which is that area described as follows:

Commencing at the intersection of Ingall Road and the Michigan Ohio-line, Medina Township, Lenawee County; T8S, R1E, north to the intersection of Ingall Road and the Norfolk and Western Railroad, southwesterly along the Norfolk and Western Railroad to the east line of Section 32, north to Packard Road, east ¼ mile, north to the north line of Section 9, west to Acker Highway, south to a point ¼ mile north of Packard Road, west ¼ mile, south ½ mile, west ¼ mile, south to Lime Creek Road, west to Meridian Road, north to the northwest corner of Section 24, T8S, R1W, Wright Township, Hillsdale County; west to the northwest corner of Section 20, south to the west ¼ post of Section 30, west to Pittsford Road, south on Pittsford Road to the Michigan-Ohio line, easterly along the boundary line to the point of beginning.

This information was previously shown on Original Sheet 6.0.

Issued: February 2, 2005

Effective: March 1, 2005

Issued under the authority of the PA 179, Michigan Telecommunications Act as amended.

By: Mark Bernath, Vice President

Waldron, Michigan

LOCAL TELEPHONE EXCHANGE SERVICE

EXCHANGE SERVICE AREA
(Licensed to Serve)

Exchange: Waldron

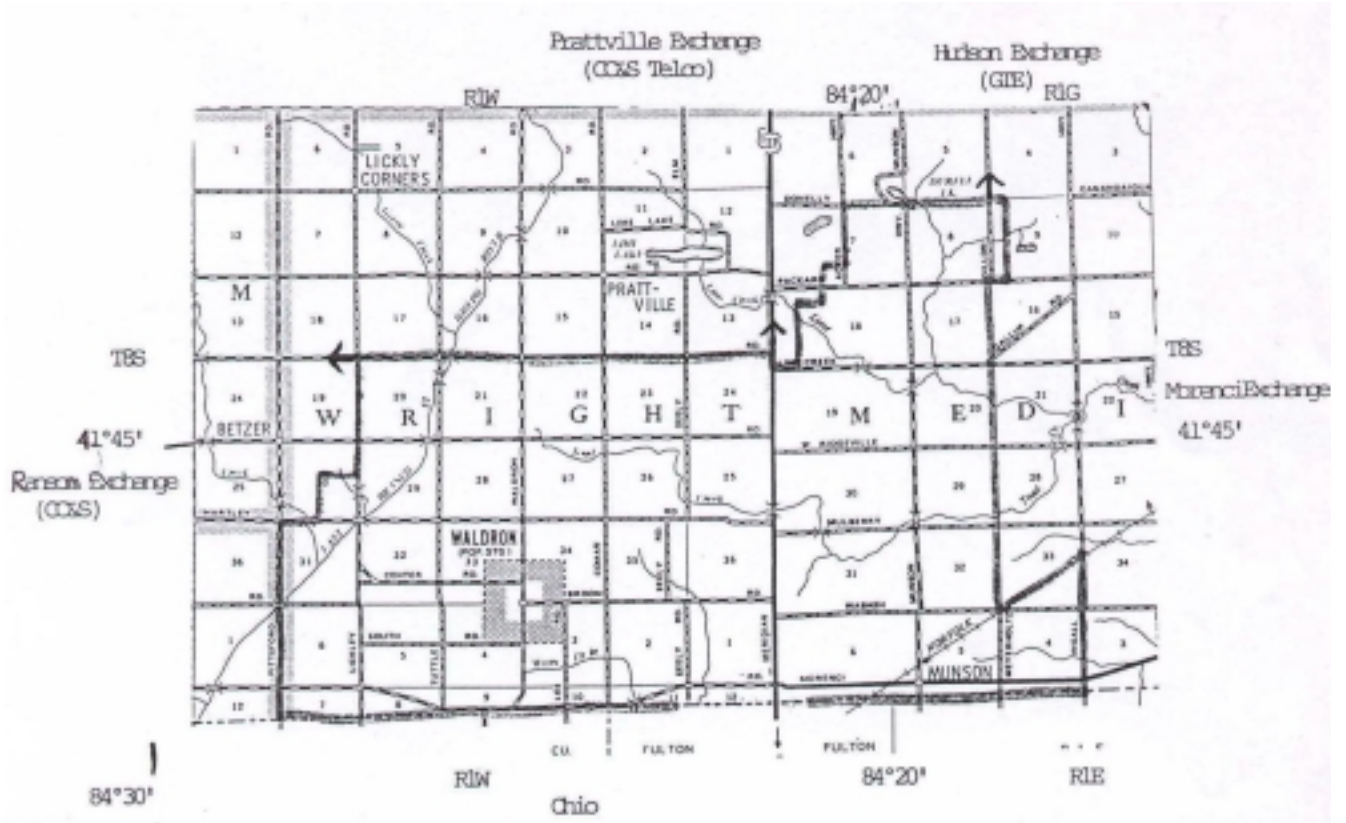

0

Issued: March 22, 1993

Effective: March 22, 1993

Issued under the authority of the Michigan Public Service
Commission Order dated December 22, 1992, in Case No. U-10064.

By: Kathryn Fox, President

Waldron, Michigan

LOCAL TELEPHONE EXCHANGE SERVICE
APPLICATION OF BOUNDARY DESIGNATIONS

A. GENERAL

1. Application of Boundary Designations

- a. Boundaries for Base Rate Areas, Locality Rate Areas and the service areas for Exchanges are designated on maps in Tariff M.P.S.C. No. 1.
- b. Each establishment is within only one Exchange service area except as provided in c. below.
- c. Where the boundary is designated as a road (street or highway) the area includes that side of the highway on which are located the general plant facilities serving both sides of the highway. When such facilities are located on the near side of the highway, a customer located on the opposite side is considered to be within the area if he can be served by a drop wire using not more than one additional pole; when the general facilities are located on the far side of the boundary, a customer on that side is considered to be within the area if he can be served by means of a drop wire not requiring any additional poles.
- d. Where the boundary is designated as the center of the road (street or highway) each side of the road is in a different service area.
- e. Where the boundary is designated as a river (stream) or railroad each side of the river or railroad is in a different service area.
- f. Where the boundary divides a lake, the shore of the lake is in different service areas in accordance with the boundary designation at the shore line.
- g. Where the boundary is designated as a Township Section Line or a specified distance from a Township Section Line, customers are served in accordance with their location with respect to such boundary line. When such a line is other than the section line or one quarter or one half mile from a section line, the location of the boundary line with respect to the section line will be show in feet or fractional miles on the Tariff Map Sheet.

Issued: March 22, 1993

Effective: March 22, 1993

Issued under the authority of the Michigan Public Service
Commission Order dated December 22, 1992, in Case No. U-10064.

By: Kathryn Fox, President

Waldron, Michigan

LOCAL TELEPHONE EXCHANGE SERVICE
SERVICE CONNECTION, MOVE AND CHANGES

A. SERVICE CONNECTION CHARGES

1. Service Connection Charges are applicable with the establishment of new and additional exchange telephone service as specified in the Telephone Company's Tariffs and are in addition to all other rates and charges applying under the Tariffs.
2. Service Connection Charges also apply as follows:
 - a. When there is a change in the party known as the customer (change of interest) which requires the telephone company to discontinue billing for one customer and establish billing for another customer.
3. Service Connection Charges do not apply to the following:
 - a. When there is a change in name and/or a change of interest which does not require the telephone company to discontinue billing for one customer and establish billing for another customer.
4. Restoral of Service
 - a. A Restoral of Service Charge will apply where service has been discontinued for non-payment of any charges due or for failure of the subscriber to establish credit in accordance with regulations as set forth in Tariff M.P.S.C. No. 7. The charge applies for reconnecting all service and facilities at one location.
 - b. The charge for Restoral of Service is as shown on Sheet 10.1 of Tariff M.P.S.C. No. 1.
5. Promotional Waiver:

Service Charges may be waived by the Company during promotional periods for the services listed below. The waiver of Service Charges will not exceed a total of 62 days in any calendar year for each service. Customer orders for the service which are completed or taken during the promotional period will qualify for the waiver of Service Charges. The following services are approved for a waiver of Service Charges and/or the waiver of the monthly rate for the first thirty days of service as specified elsewhere in the Company Tariffs:

 - (1) Touch Call Service
 - (2) Multiline Variety Package (MVP)

Issued: March 22, 1993

Effective: March 22, 1993

Issued under the authority of the Michigan Public Service
Commission Order dated December 22, 1992, in Case No. U-10064.

By: Kathryn Fox, President

Waldron, Michigan

LOCAL TELEPHONE EXCHANGE SERVICE
SERVICE CONNECTION, MOVE AND CHANGES

B. CHARGES

		Business	Residence
1.	Each line, Service Connection only	\$ 20.00	\$ 15.00
2.	Restoral of Service	12.00	12.00

Issued: March 22, 1993

Effective: March 22, 1993

Issued under the authority of the Michigan Public Service
Commission Order dated December 22, 1992, in Case No. U-10064.

By: Kathryn Fox, President

Waldron, Michigan

LOCAL TELEPHONE EXCHANGE SERVICE

LIFELINE SERVICE

A. DESCRIPTION

1. Lifeline Service applies discounts to monthly recurring rates for qualifying residential customers. These discounts are applied to existing tariffed rates and charges for residential telephone service. (D)
2. In order to be eligible for Lifeline Service a residential customer's household income must be at or below 150% of the poverty level as determined by the United States Office of Management and Budget and as approved by the State Treasurer or the customer must participate in one of the following federal assistance programs: (N)
 - a. Medicaid
 - b. Food stamps
 - c. Supplemental security income
 - d. Federal public housing assistance
 - e. Low-income home energy assistance program
 - f. National school lunch program's free lunch program
 - g. Temporary assistance for needy families.
3. Lifeline Service includes the services and functionalities enumerated in by the F.C.C. as follows: voice grade access to the public switched network; local usage; dual tone multi-frequency signaling or its functional equivalent; single-party service or its functional equivalent; access to operator services; access to interexchange service; access to directory assistance; and toll blocking for qualifying customers.
4. Other services can be provided with the Lifeline Service at applicable rates and charges.

h. REGULATIONS

1. Regulations specified elsewhere in the Company's tariffs apply to Lifeline Service.
2. Lifeline Service is available only with residence services, excluding foreign exchange service. Lifeline Service is limited to one line per household at the customer's primary residence.
3. A miscellaneous service charge does not apply when Lifeline Service is added or discontinued to existing service when that is the only work being done.
4.
 - a. A discount of 20% of the Basic Local Exchange rate or \$11.25, whichever is greater, on the monthly rate for Basic Local Exchange Service for Lifeline customers is applicable. For Lifeline customers 65 years of age or more, the discount will be 25% of the Basic Local Exchange rate or \$12.35, whichever is greater. The total discount shall not exceed 100% of all end-user common line charges and the Basic Local Exchange rate. (C)
 - b. The credit will be applied in the following order: (1) The Interstate End User Access Charge, National Exchange Carriers Association, Inc. Tariff F.C.C. No. 5, Access Service. (2) End User Common Line charge, Michigan Exchange Carriers Association (MECA), Tariff M.P.S.C. No. 25, Part XVII, Section 17.1.2. and (3) The balance of the credit, if any, will be applied as a credit to the Basic Local Exchange rate.
 - c. The Company will provide, at the qualifying customer's option, toll blocking service at no charge. The Company defines toll blocking as a service provided by the Company that lets the customer elect not to allow the completion of outgoing toll calls from their telecommunications channel.
 - d. The Company will not require a service deposit in order to initiate Lifeline Service if the qualifying customer voluntarily elects toll blocking service.
 - e. The Company will not disconnect Lifeline Service for non-payment of toll charges by qualifying customers.
5. The Lifeline plan will apply after receipt and processing of a completed Company or community/government provided application, including documentation indicating that the household income meets the eligibility standards established above.
6. Customers of Lifeline Service must notify the Company of any changes which would affect qualification. Reverification of eligibility will take place on an ongoing basis. When the customer is no longer eligible for Lifeline service, the Lifeline discount would be discontinued and regular tariff rates and charges would apply.

Issued: January 10, 2006

Effective: January 11, 2006

Issued under the authority of Public Acts 179 of 1991, 216 of 1995, 295 of 2000 and 235 of 2005.

By: Mark Bernath, Vice President

Waldron, Michigan

LOCAL TELEPHONE EXCHANGE SERVICE

LIFELINE SERVICE

C. MONTHLY RATE FOR NON LIFELINE CUSTOMERS

A rate specified in MECA's Tariff M.P.S.C No. 25 Part XVII, Section 17.1.2.1 applies per exchange access line to cover the costs of the Lifeline service, to the Telephone Company intrastate services as listed below:

- Business and Residence exchange services excluding Lifeline customers.
- PBX Trunk Services
- Centrex Services

The rate for business Centrex station lines will be computed based on the trunk Equivalence Table specified in the Company's Tariff M.P.S.C. No. 2.

D. LINK UP PROGRAM

1. A discount on the line connection charges, specified elsewhere in this tariff, is also available to qualifying customers, for the installation or transfer of service from one residential premises to another. (C)
2. a. In order to be eligible for the Link Up Program, a residential customer's household income must be at or below 150% of the poverty level as determined by the United States Office of Management and Budget and as approved by the State Treasurer. (D) (N)
- b. A qualifying customer may receive a reduction in the installation charges, or transfer of service charges, for connection at the customer's principal place of residence of half the customary charge or \$30.00, whichever is less.
- c. A qualifying customer may then make payments for the connection charges on a deferred schedule in which the qualifying customer does not pay interest. The interest charges not charged to the qualifying customer shall be for connection charges of up to \$200.00 that are deferred for a period not to exceed one year. Charges assessed for installation or transfer of service include any charges that the Company customarily assesses to connect subscribers to the network. These charges do not include any permissible security deposit requirements.
- d. A qualifying customer may choose one or both of the programs set forth in 2.a. and 2.b. of this section.
- e. A qualifying customer can receive the benefits of the Link Up Program for a second and subsequent time only for a principal place of residence with an address different from the residence address at which the Link Up assistance was provided previously. (N)

Issued: December 18, 1997

Effective: January 1, 1998

Issued under the authority Public Act 216.

By: Kathryn Fox, President

Waldron, Michigan

FEDERAL PROGRAMS

1. UNIVERSAL SERVICE SUPPORT FOR LIBRARIES AND SCHOOLS

1. In accordance with 1997 PA 95 of the Michigan Telecommunications Act, and 47 CFR 54.500 *et. seq.*, eligible elementary and secondary schools shall receive intrastate services at discounts equal to the discounts applicable for eligible interstate services if the Company receives federal universal support for such telecommunication services.
2. In accordance with 1997 PA 96 of the Michigan Telecommunications Act, and 47 CFR 54.500 *et seq.*, eligible libraries shall receive intrastate services at discounts equal to the discounts applicable for eligible interstate services if the Company receives federal universal support for such telecommunication services.
3. Eligibility for discounts shall be determined in accordance with 47 CFR 54.500 *et seq.*

2. UNIVERSAL SERVICE SUPPORT FOR HEALTH CARE PROVIDERS

1. In accordance with 47 CFR 54.601 *et. seq.*, the Company shall offer services to eligible health care providers to the extent that facilities and services are available.
2. Eligibility qualifications, provider selection, etc. shall be determined in accordance with 47 CFR 54.601 *et. seq.*
3. Services to eligible health care providers at reduced rates will be offered in accordance with 47 CFR 54.601 *et. seq.*
4. Reduced rates to eligible health care providers are available only to the extent that adequate funding is available from the federal universal support fund.

Issued: January 6, 2000

Effective: January 7, 2000

Issued under authority of 1991 PA 179 as amended.

By: Kathryn Fox, President

Waldron, Michigan